



32, Bishopscourt Road, Sheffield, S8 9HP

# 32, Bishopscourt Road

Sheffield, S8 9HP

## Description

A lovely three bedroom semi detached property situated just around the corner from Meersbrook Park and the local amenities in Heeley and Meersbrook with more comprehensive facilities found a little further afield at Woodseats. This pretty home has recently been reroofed and re-rendered and has a large conservatory situated off the modern, open plan dining kitchen which has added valuable and additional reception space to this home. There is also a finished loft space (accessible via a loft ladder from the rear double bedroom) that offers potential to be developed further if required (subject to regs). A huge part of this homes attraction is the stunning views that are obtained from the westerly facing garden. The contrast between the urban setting and the sweeping panorama over Sheffield's city centre skyline really is something to behold and provides a lovely, contrasting background to the well stocked, mature garden.

- No onward chain.
- Three bedrooms including two doubles with fitted wardrobes.
- Open plan breakfast kitchen with French windows opening to the conservatory.
- Large UPVC double glazed conservatory with electric heater, hipped and pitched polycarbonate roof and further French windows leading into the garden.
- Cosy sitting room with bay window and feature white marble surround to the fireplace.
- Family bathroom with mixer shower situated over the bath.
- Low maintenance front garden.
- Pretty rear garden enjoying a panoramic view over the Steel City.
- Entrance lobbies to the front and side.
- UPVC double glazing and gas central heating.





Ground Floor  
49 sq m/527.43 sq ft  
Approx.

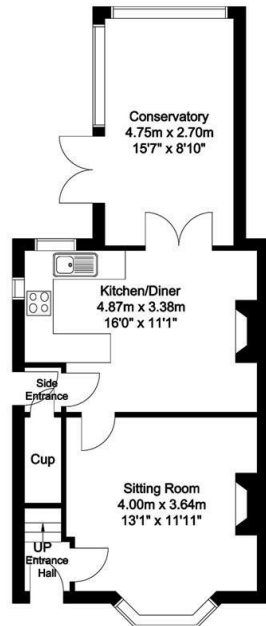

First Floor  
35 sq m/376.73 sq ft  
Approx.

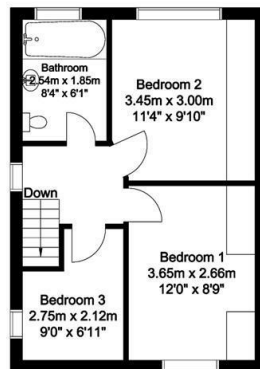

Second Floor  
19 sq m/204.51 sq ft  
Approx.

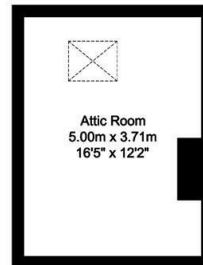

Whilst every attempt has been made to ensure the accuracy of the floor plan contained here, no responsibility is taken for incorrect measurements of doors, windows, appliances and rooms or any error, omission or misstatement. Exterior and interior walls are drawn to scale based on interior measurements. Any figure given is for initial guidance only and should not be relied on as a basis of valuation. The plans are for marketing purposes only and should only be used as such. No guarantee is given on the accuracy of the total square footage/ meterage if quoted on this plan. CP Property Services @2022



**Bakewell**  
3 Royal Oak Place  
Matlock Street  
Bakewell DE45 1HD  
T: 01629 700699  
E: bakewell@elr.co.uk

**Banner Cross**  
888 Ecclesall Road  
Banner Cross  
Sheffield S11 8TP  
T: 01142 683388  
E: bannercross@elr.co.uk

**Dore**  
33 Townhead Road  
Sheffield  
S17 3GD  
T: 0114 2362420  
E: dore@elr.co.uk

**Hathersage**  
Main Road, Hathersage  
Hope Valley  
Derbyshire S32 1BB  
T: 01433 651888  
E: peakdistrict@elr.co.uk

**Rotherham**  
149 Bawtry Road  
Wickersley  
Rotherham S66 2BW  
T: 01709 917676  
E: wickersley@elr.co.uk

**EADON  
LOCKWOOD  
& RIDDLE**  
ESTD 1840

All rooms have been measured with electronic laser and are approximate measurements only. None of the services to the above property have been tested by ourselves, and we cannot guarantee that the installations described in the details are in perfect working order. Eadon Lockwood & Riddle for themselves, and for the vendors or lessors, produce these brochures in good faith, and are a guideline only. They do not constitute any part of a contract and are correct to the best of our knowledge at the time of going to press.